

Tilt Outdoor Kitchen Technical Specifications

Tait.

UPDATED - 18.02.24



The Tilt Outdoor Kitchen combines Tait's love for backyard living and barbecuing in a sleek, compact, multi-functional package. It's an open and shut case, setting the gold standard for outdoor entertaining. Tilt is available with a traditional gas barbecue, or an electric Teppanyaki grill, with the basic model including your premium cooktop option and stainless-steel benchtop. Beyond that, the sky is the limit!

- Electric Teppanyaki grill or
- Gas stainless-steel barbecue with roasting hood
- Folded aluminium and stainless-steel sheet
- Powder coated aluminium batons
- Stainless steel bench top
- Custom UV-stable powder coat
- Accessory shelves

Designed for entertaining outdoors, Tilt has been created to withstand harsh Australian conditions. Spanning commercial to residential, hospitality to corporate applications, Tilt showcases resolved sophistication in each facet of the design and manufacture process.

Providing the ultimate option for outdoor entertaining, when closed, the Tilt Outdoor Kitchen forms a compact, contemporary and minimal box that – even when not in use – will make a stylish statement in your outdoor space.

Featuring folded aluminium and stainless-steel sheets, powder-coated aluminium batons, custom UV-stable powder coats and a stainless-steel benchtop, cooktop options include the stainless-steel Beefeater barbecue with roasting hood (gas) or the Teppanyaki grill (electric) with optional extras including integrated LED lighting, UV protective awning, premium sink with tap and weather resistant cover.

Tilt provides the assurance of genuine local manufacture using sustainable methodologies, quality craftsmanship, manufacturer guarantee and product longevity.

All Tait pieces are made locally and come with a 5-year structural warranty.

Tait's original designs are protected under design registration and copyright.

Extra Notes:

Manufacturer's warranty applies to non-Tait components.

1 year warranty on moving parts

POWDER COAT

TEXTURED POWDER COAT COLOURS

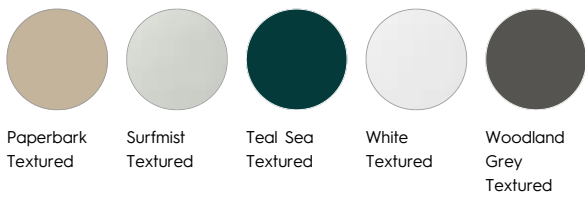

STANDARD POWDER COAT COLOURS



Tilt Outdoor Kitchen Dimensions

OPEN

1855mm_w
755mm_D
2230mm_H

86.5in W x 34.25in D x 26.5in. H
Weight 180kg

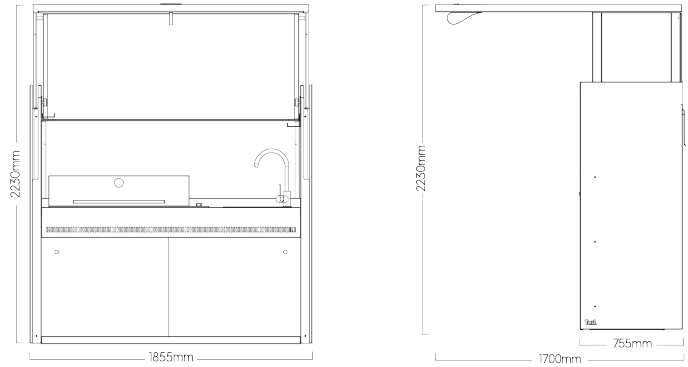

CLOSED

1855mm_w
755mm_D
1700mm_H

86.5in W x 34.25in D x 26.5in. H
Weight 180kg

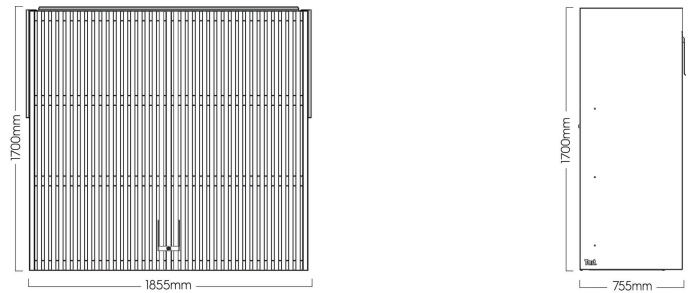

GENERAL CARE

At Tait, we make products for life. Our products are crafted from high-performance materials designed to withstand the diverse Australian elements. We nurture our craft, combining timeless and cutting-edge designs with beautiful finishes in order to elevate your outdoor (or indoor) experience.

Our collections are handcrafted from weather-resistant materials, making each piece a durable choice. In order to maintain their look and feel over time, Tait items need ongoing care and maintenance. The frequency of maintenance will vary depending on the level of care you want to provide, your personal standards and requirements as well as the environment within which the product lives.

Careless handling, treatment or misuse of our products can result in damage and is not covered under our five-year structural warranty. Please click through to the care instructions relevant to the specific materials and finishes of your product, and refer to the list to the right for warranty exclusions.

EXCLUSIONS

The warranty does not cover damage from mishandling, misuse, physical or chemical abuse, by not following proper care and maintenance instructions, accidental damage, damage from chipping, cracking, impact damage or breaking due to customer abuse.

- The warranty does not cover fading or natural ageing of the timber, non-structural defects in the timber, naturally occurring timber features, surface and end checking, or lack of maintenance leading to an acceleration of any of these issues.
- The warranty does not cover corrosion originating from scratches or abrasions that result from general wear and tear and which cannot be removed via standard cleaning and maintenance processes.
- The warranty does not cover any occurrence of any detritus, organic or man-made matter settling on the product surface. The warranty excludes buildup of mineral deposits leaching from soils and fertilisers, should it occur on Tait's planters. Nor does this warranty cover any product corrosion directly caused by aforementioned matter.
- The warranty does not cover minor corrosion spots at the weld joints: under table tops, bases and seat frames. These do not affect the structural integrity of the product and are a natural outcome of the material used.
- The warranty does not cover the corrosion of steel furniture and parts, including stainless steel, as a result of direct use in harsh seafront locations or in a confined, chlorinated environment.
- The warranty does not cover product damage caused by the build-up of mould due to environmental factors such as wet weather, damp and humidity
- The warranty does not apply to normal wear and tear or natural fading of the materials used.
- The warranty does not apply to any variances in colour, shade or gloss level of finishes, stone tops and timbers.
- The warranty does not cover products that the customer decides they do not like following delivery, including to colour, fabric, timber or other opinions based on personal preference.
- Tait shall not be liable for, and specifically excludes, any claims caused directly or indirectly by any event or matter beyond its control, including incidental, consequential or contingent damages suffered as a result of the use of the furniture or a breach of this warranty either written or implied.
- All products purchased at a sale price are subject to the specific warranty conditions outlined on sale invoice.
- The warranty does not cover transportation costs for replacement parts and products or labour costs for repair. These costs may be charged at our discretion.
- The warranty does not cover goods which have been held in storage for any period. This is due to the potential impact of environmental extremities which may be present within certain storage facilities.

The above Tait warranty terms are accepted by the customer and end-user upon order and supply.

POWDER COAT

CARE & MAINTENANCE

Wash regularly with warm soapy water and mild detergent using a soft cloth. For commercial, industrial or marine environments we recommend monthly maintenance. Always rinse well with water, to remove any remaining detergent.

Avoid steam cleaning, pressure washing, abrasive cleansers, steel brushes/wools and cleaners containing chlorine. Avoid scratching the surface by dry dusting. Never use strong solvents to clean powder coated surfaces. Aggressive solvents such as turpentine, white spirits, thinners, citrus based cleaners, Spray and Wipe, and other aggressive solvents are harmful to the extended life of the powder coated surface. Do not allow detritus, organic or man-made matter to settle on the product surface. We recommend removing any buildup of mineral deposits leaching from soils and fertilisers, should it occur on Tait's planters.

Rough treatment of powder-coated furniture can result in chipping of the coated surface; this is not covered under warranty.

Most Tait products come with protective fittings - stacking glides, bumpers, socks/feet and glides. These aid in protection against chipping and scratching. Powder coated chairs are designed to be set in place gently.

Touch-up paint may be purchased on request. It is advisable to repair minor nicks and scratches as soon as they appear.

When placing a furniture cover over a table for an extended period of time, it is recommended to first place an empty plastic pot plant in the centre of the table, then placing the furniture cover over the top. This will prevent the possibility of the furniture cover adhering to the table surface.

Should you wish to touch up any blemishes which may occur, please contact your nearest Tait showroom and request a Powder Coat Touch Up Kit. Please follow our Powder Coat Touch Up

How to care for your Tilt Outdoor Kitchen

Tait.

Guide (available under 'Dimensions and Specs - Download Assets' on the product page) for application details.

WARRANTY

Powder coat is a decorative finish for indoor and outdoor use. While it assists with metal protection, it is not a corrosion protection in its own right. The components of Tait powder coated products are produced in either aluminium, stainless steel or mild steel.

The mild steel base materials are treated with two levels of pre-protection that guard against corrosion. The products are then powder coated to make the surface resistant to corrosion and suitable for use in exterior environments.

Minor corrosion spots at the weld joins - under table tops, bases and seat frames, may be evident on mild steel products. These do not affect the structural integrity of the product and are not covered by the Tait warranty.

Whilst every care is taken to provide the most suitable finish according to the use and the environment the product will be subjected to, Tait cannot guarantee this decorative finish against scratching, scuffing, chipping, fading or corrosion as a result of use in harsh seafront, extreme or environments where chlorine is present.

Tait offer a range of powder coat colours which offer excellent UV stability and are suitable for use in outdoor applications. Whilst powder coat offers excellent colour retention, natural fading is not covered under the Tait warranty. To ensure longevity of this finish please refer to the care and maintenance.

The warranty does not cover any occurrence of detritus, organic or man-made matter settling on the product surface. The warranty also excludes buildup of mineral deposits leaching from soils and fertilisers, should it occur on the surface of Tait's planters. Nor does this warranty cover any product corrosion directly caused by aforementioned matter.

Tait assume no responsibility for product damage caused by the use of furniture covers.

STAINLESS STEEL

CARE & MAINTENANCE

Stainless steel is the top quality in terms of anti-corrosion, longevity and lower-than-low-maintenance. Here at Tait we use both electro and hand polished stainless steel. Looking after it is an easy task.

DO:

- Wash your stainless pieces regularly with soapy water and a clean cloth
- If necessary, a Scotch-Brite pad and extra elbow grease will do no harm
- Use a non-abrasive cream cleaner or commercial cleaner for more stubborn marks
- Clean in one direction along the original polish lines

DO NOT:

- Use steel wool or metallic scrapers
- Allow dirt to accumulate

A WORD ON TEA-STAINING

In a salty sea-air environ stainless steel can be prone to "tea-staining" (usually within 5km of the surf) recognisable by surface discolouration caused by a build-up of environmental elements.

Tea-staining is no cause for alarm as it is purely cosmetic and does not affect the structural integrity of the material. An electro-polished finish will reduce the occurrence of tea staining, but should it occur, it will clean right off with hot soapy water and a bit of elbow grease.

Careless handling, treatment or misuse of our products can result in damage and is not covered under our manufacturer's warranty.

WARRANTY

Tait provides a 5-year warranty on stainless steel framework against structural defects. The corrosion of stainless steel and steel parts due to use in a confined chlorinated environment or as a result of direct use in harsh seafront locations which are not covered under warranty. Tea staining will occur on Stainless Steel and is not covered by the Tait warranty.

How to care for your Tilt Outdoor Kitchen

Tait.

SUITABLE FOR



OUTDOORS



HIGH UV

FEATURES



MADE IN
AUSTRALIA



RECYCLABLE
MATERIALS



5 YEAR
STRUCTURAL
WARRANTY